

## ELO® DESK/TABLE



NOTE: These instructions are based on model #ELO7601-ADJ. These instructions work for all ELO® desk & table models. Product images are for illustrative purposes only and may differ from actual product.



The assembly of this desk requires the assistance of another person.



### TOOLS NEEDED



Drill



4mm Allen Wrench



4mm Hex Bit

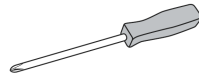

Phillips Screwdriver

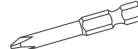

Phillips Drill Bit

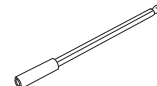

Drill Bit Extension



Assistance

### PARTS



PARTS x QTY

#	DESCRIPTION x QTY
A	Laminate Top x 1
B	Leg x Qty Varies
C	Leg Plate x Qty Varies (Attached to Leg)
D	Footing x Qty Varies
E	Backpack Hook x 1 (Optional)

### HARDWARE x QTY

GLIDES	FASTENERS
<p><b>Hardware D x 1 per leg</b> 2.5" Grand Hank nylon glide, 3/8"-16x1" 040164</p>	<p><b>Hardware G x 6 per leg plate</b> 1/4"-20x19mm joint connector bolts 04088861</p>
<p><b>Hardware D x 1 per leg</b> 1.5" soft touch glide 04067920</p>	<p><b>Hardware J x 10</b> #8x3/4" screws 0404248</p>
<p><b>Hardware D x 1 per leg</b> 1.25" steel glide NSL-33056S</p>	MISCELLANEOUS
<p><b>Hardware F x 1 per leg</b> Dual wheel soft tread locking caster 04067540</p>	<p><b>Hardware E x 1</b> 2" Backpack Hook 04066852</p>
<p><b>Hardware K x 1</b> Star Washer 04069034</p>	<p><b>Hardware M x 1</b> 1/4"x20x25mm Joint connector bolt 04069034</p>
	<p><b>Hardware H x 0-2 depending on model</b> Support Bar 04009377 (42"), 04066738 (50") 0407127 (60"), 0407118 (72")</p>

## PARTS

### Adjustable Legs

Code	Smooth Silver SKU	Black SKU	Description	Weight	Height"
ELO -ADJ	0400570-G4	0400570	ELO® 1.25" Square Adj. Leg	5	25 - 30
ELS -ADJ	04067832-G4	04067832	ELO® 2" Straight Round Adj. Leg	6	25 - 40
ELP -ADJ	04066829-G4	N/A	ELO® 2" Straight Round Pin Adj. Leg	6	25 - 39



### Jr. Adjustable Legs

Code	Smooth Silver SKU	Black SKU	Description	Weight	Height"
ELO -EJA	0400755-G4	0400755	ELO® 1.25" Square Jr. Adj. Leg	5	20 - 25
ELS -EJA	04066652-G4	04066652	ELO® 2" Straight Round Jr. Adj. Leg	6	20 - 33
ELP -EJA	04066785-G4	N/A	ELO® 2" Straight Round Pin Jr. Adj. Leg	6	19 - 29



### Fixed Legs

Code	Smooth Silver SKU	Black SKU	Description	Weight	Height"
ELS -FX	04067792-G4	N/A	ELO® 2" Round Fixed Leg w/Grand Hank Glide	4	28.11
ELS -FX-CA	04067839-G4	N/A	ELO® 2" Round Fixed Leg w/Dual Wheel Soft Tread Locking Caster	4	28.11



### Mini Jr. Adjustable Leg

Code	Smooth Silver SKU	Black SKU	Description	Weight	Height"
ELS -MJA	04067425-G4	N/A	ELO® 2" Round Jr. Adj. Mini Leg w/Grand Hank Glide	4	10.75 - 17.75



### Desks

#### # of Legs

Connect 4	3
Diamond	3
Mini Diamond	3
Mini Nimubs	3
Pyramid	3

### Tables

#### # of Legs

#### # of Support Bars

Rectangle up to 72" L	4	1 (only on 72"L)
Rectangle 84" & 96" L	6	-
Kidney (221)	4	1

### Shaped Tables

#### # of Legs

Benton	5
Delta	5
Double Delta	6
Flower	6
Horseshoe (240)	5
Horseshoe (244)	5
Horseshoe (241)	5
Manta	3
Nimbus	3
Tri-	6

### Court Tables

#### # of Legs

#### # of Support Bars

36"D X (60"L & 72"L)	4	1
36"D X 96"L	5	1
42"D x (60"L - 96"L)	5	1
48"D X (60"L - 84"L)	5	1
48"D X 96"L	6	1
60" D x (60"L - 66"L)	5	2



NOTE: Hardware packs are included in packaging. You may receive more hardware than needed. Discard any extra hardware after assembly.



CAUTION! Some parts may have sharp edges. Care must be taken when handling various pieces to avoid injury. For your safety, wear a pair of work gloves when assembling.

## ASSEMBLY

1. Place **Part A** face down on a protected flat surface so threaded inserts are facing up.

2. Align pre-drilled holes in **Part C** (that is attached to **Part B**) with threaded inserts in **Part A**.

Using a screw gun, 4mm hex bit and a drill bit extension, connect **Part C** to **Part A** using **Hardware G**.

Repeat this step for the remaining legs.

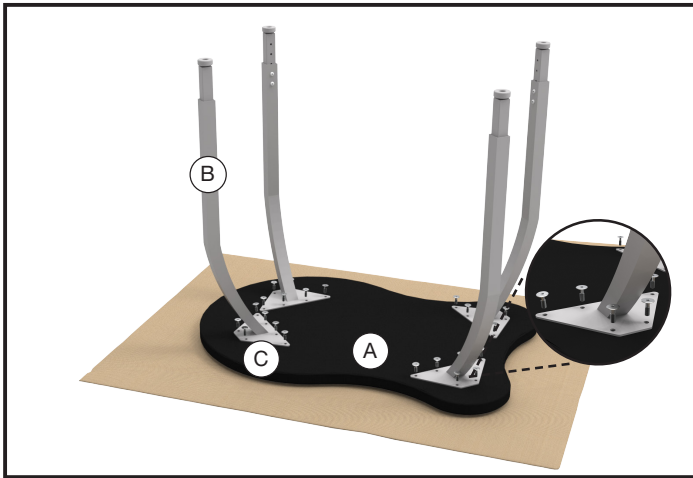

3. If your table requires **Hardware H**, align the bar(s) with the pre-drilled pilot holes in the top, attach using **Hardware J**.

4. If **Hardware D** or **Hardware F** was ordered, remove nylon glide from leg by rotating counter-clockwise until glide is free from **Part B**.

Place stem of **Hardware D** or **Hardware F** into the hole of the leg. Rotate clockwise until fully inserted into the leg.

Tighten with a 14mm open-ended wrench (only with dual-wheel casters.)

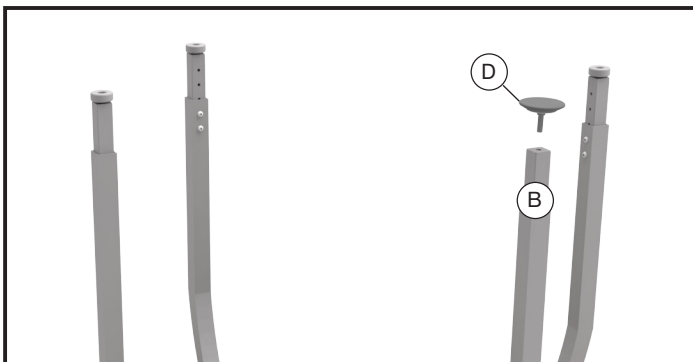

NOTE: Casters are not to be used as a leveling device. Please make sure that casters are tightened all the way to prevent possible damage to the stem of the caster.

5. If **Hardware E** was ordered, place **Hardware M** through the backpack hook, then through **Hardware K**. Fasten through **Part C** to **Part A**.

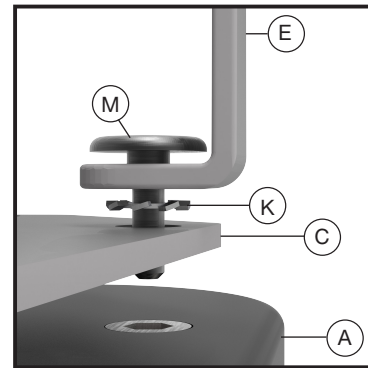

6. Adjust legs to desired height.

7. With assistance, turn desk upright.

