

### Classic Construction (/C)

<i>Case</i>	Sides, back and sub-top/sub-bottom are constructed using fully doweled 0.75" particle board, 3mm PVC edge banding (matching, unless otherwise specified).
<i>Drawers</i>	0.75" matching front w/3mm PVC edge banding (matching, unless otherwise specified), 4" satin nickel wire pulls, standard full extension side mount steel ball bearing glides
<i>Doors</i>	'0.75" double sided TFL, 3mm PVC edge banding (matching, unless otherwise specified), 4" satin nickel pulls and 6-point adjustable concealed hinges (European hinge)
<i>Shelves</i>	Double-sided TFL, 3mm PVC edge banding (matching, unless otherwise specified) on front edge, adjustable shelves have four double-pin shelf clips per shelf to prevent the shelves from sliding out or tipping, fixed are fully doweled
<i>Modular Base</i>	Integrated, matching fully finished 4" base, 3mm PVC edge banding (matching, unless otherwise specified), built-in levelers adjustable from inside of cabinet

### Premium Construction (/P)

<i>Premium Construction</i>	Premium cabinets are constructed the same as Classic cabinets, except the Premium cabinet components are double sided high pressure laminate (HPL) in place of the double sided TFL.
-----------------------------	--------------------------------------------------------------------------------------------------------------------------------------------------------------------------------------

### Features

<i>Whiteboards</i>	Aluminum horizontal sliding panel system with two whiteboards standard, optional third whiteboard. Porcelain-on-steel marker surface guarantees a durable, high-performance board. Marker board frame constructed of anodized aluminum trim and includes a cork map rail. Magnetic panels glide on nylon rollers for smooth operation. Finger pull for easy operation and tray for markers.
--------------------	---------------------------------------------------------------------------------------------------------------------------------------------------------------------------------------------------------------------------------------------------------------------------------------------------------------------------------------------------------------------------------------------

### Assembly

<i>On Site Assembly</i>	Each individual cabinet comes fully doweled. Assembly of of entire unit to include installation of the board and rail system required on site. See assembly instructions on our website: <a href="http://www.wibenchmfg.com/resources/product-information/">www.wibenchmfg.com/resources/product-information/</a>
-------------------------	-------------------------------------------------------------------------------------------------------------------------------------------------------------------------------------------------------------------------------------------------------------------------------------------------------------------

### Additional Options

	<i>Adder Code</i>	<i>Description</i>
<i>Locks</i>	N/A	Deadbolt locks per location

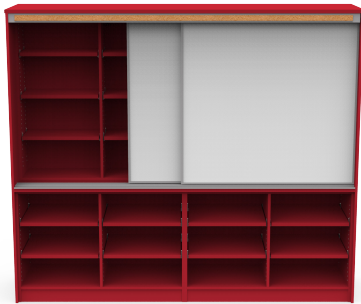

SSW0801

### 8 ft Wall

Model #	W" x H"	Overall Depth"	Description
SSW0801	96 x 84	24.35	(2) 48" open base units w/adjustable shelves/dividers (2) 48" wall hutch units w/adjustable shelves/dividers (2) porcelain whiteboards

Top Cabinet D: 17.75", Base Cabinet D: 23"

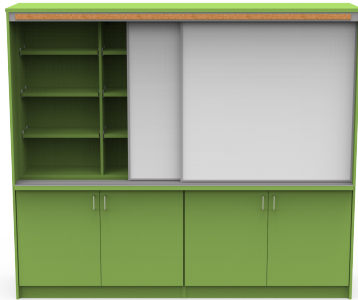

SSW0802

### 8 ft Wall

Model #	W" x H"	Overall Depth"	Description	# of Optional Locks Required
SSW0802	96 x 84	24.35	(2) 48" 2-door base units w/adjustable shelves/dividers (2) 48" wall hutch units w/adjustable shelves/dividers (2) porcelain whiteboards	4 optional deadbolt locks

Top Cabinet D: 17.75", Base Cabinet D: 23"



SSW0804

### 8 ft Wall

Model #	W" x H"	Overall Depth"	Description	# of Optional Locks Required
SSW0804	96 x 84	24.35	(2) 32" 2-door base units w/adjustable shelf (1) 32" 3-drawer base unit (2) 48" wall hutch units w/adjustable shelves/dividers (2) porcelain whiteboards	5 optional deadbolt locks

Top Cabinet D: 17.75", Base Cabinet D: 23"



SSW1001

### 10 ft Wall

Model #	W" x H"	Overall Depth"	Description	# of Optional Locks Required
SSW1001	120 x 84	24.35	(2) 30" 2-door base units w/adjustable shelves (2) 30" open base units w/adjustable shelves (2) 36" and one - 48" wall hutch w/adjustable shelves (2) porcelain whiteboards	2 optional deadbolt locks

Top Cabinet D: 17.75", Base Cabinet D: 23"



SSW1002

### 10 ft Wall

Model #	W" x H"	Overall Depth"	Description	# of Optional Locks Required
SSW1002	120 x 84	24.35	(2) 30" 2-door base units w/adjustable shelf (2) 30" 2-door/2-drawer base units w/adjustable shelf (2) 36" and one - 48" wall hutch w/adjustable shelves (2) porcelain whiteboards	8 optional deadbolt locks

Top Cabinet D: 17.75", Base Cabinet D: 23"



SSW1004

### 10 ft Wall

Model #	W" x H"	Overall Depth"	Description	# of Optional Locks Required
SSW1004	120 x 84	24.35	(2) 40" 2-door base units w/adjustable shelf (1) 40" 3-drawer base unit (2) 36" and (1) 48" wall hutch w/adjustable shelves (2) porcelain whiteboards	7 optional deadbolt locks

Top Cabinet D: 17.75", Base Cabinet D: 23"



SSW1201

### 12 ft Wall

Model #	W" x H"	Overall Depth"	Description	# of Optional Locks Required
SSW1201	144 x 84	24.35	(3) 48" 2-door base units w/adjustable shelves/dividers (3) 48" wall hutch units w/adjustable shelves/dividers (2) porcelain whiteboards	6 optional deadbolt locks

Top Cabinet D: 17.75", Base Cabinet D: 23"



SSW1202

### 12 ft Wall

Model #	W" x H"	Overall Depth"	Description	# of Optional Locks Required
SSW1202	144 x 84	24.35	(2) 36" 2-door base units w/adjustable shelf (2) 36" 2-door/2-drawer base units w/adjustable shelf (3) 48" wall hutch units w/adjustable shelves/dividers (2) porcelain whiteboards	8 optional deadbolt locks

Top Cabinet D: 17.75", Base Cabinet D: 23"



SSW1204

### 12 ft Wall

Model #	W" x H"	Overall Depth"	Description	# of Optional Locks Required
SSW1204	144 x 84	24.35	(2) 48" 2-door base units w/adjustable shelves/dividers (1) 48" 6-drawer base unit (3) 48" wall hutch units w/adjustable shelves/dividers (2) porcelain whiteboards	10 optional deadbolt locks

Top Cabinet D: 17.75", Base Cabinet D: 23"



SSW1211

TV & hardware to mount TV are not included.  
Support bars included for back panel and subtop.

### 12 ft Wall

Model #	W" x H"	Overall Depth"	Description	# of Optional Locks Required
SSW1211	144 x 84	24.35	(2) 48" top-split drawers over 2-door base units w/adjustable shelves/dividers (1) 48" 2-door base unit w/adjustable shelves/divider (2) 39" wall hutch units w/adjustable shelves/dividers (4) 36" porcelain whiteboards (1) 64.5" Opening to fit up to 70" TV	10 optional deadbolt locks

Top Cabinet D: 17.75", Base Cabinet D: 23"